



## PRODUCT SHEET

# EROAD ETRACK WIRED

Delivering full fleet coverage for optimised productivity and utilisation.

By pairing the right technology to the right assets we can deliver the best possible solution for tracking and managing all of your powered assets and equipment.

ETrack Wired complements our in-cab solution to provide visibility and management of all your assets, vehicles and auxiliary equipment.

The ETrack Wired is an easily installed, discreet and durable tracking device that connects to your plant's power system and provides accurate reporting of engine hours and location with accuracy and high frequency.

**ETrack Wired** is built on EROAD's legacy of precision and reliability and also provides an easy installation and onboarding experience for registered and non-registered plant alike.

**ETrack Wired's** location reporting frequency is fine tuned to capture your assets' operating behaviour and provide periodic updates when your assets are on the move between sites.

**ETrack Wired** not only covers your primary assets but also gives full visibility and tracking of your auxiliary equipment usage - including hours of usage and location tracking that enables accurate Proof of Service reporting and service management.

*Utility is a rugged and environmentally sealed device, meaning it's up to the task no matter what piece of equipment you wish to monitor.*

## KEY BENEFITS

### Full fleet tracking

Visibility and management of all your assets, vehicles and auxiliary equipment

### Rugged and accurate

A watertight, rugged, easily installable, wired device with a small footprint that delivers superior tracking performance

### Accurate Proof of Service reporting

With a high level of accuracy, accelerometers, geofencing and 2 I/O ports you can connect seamlessly to EROAD Proof of Service reporting to deliver outstanding customer service

### Auxiliary equipment monitoring

Full visibility and tracking of your auxiliary equipment usage - including hours of usage and location tracking that enables accurate proof of service reporting and service management

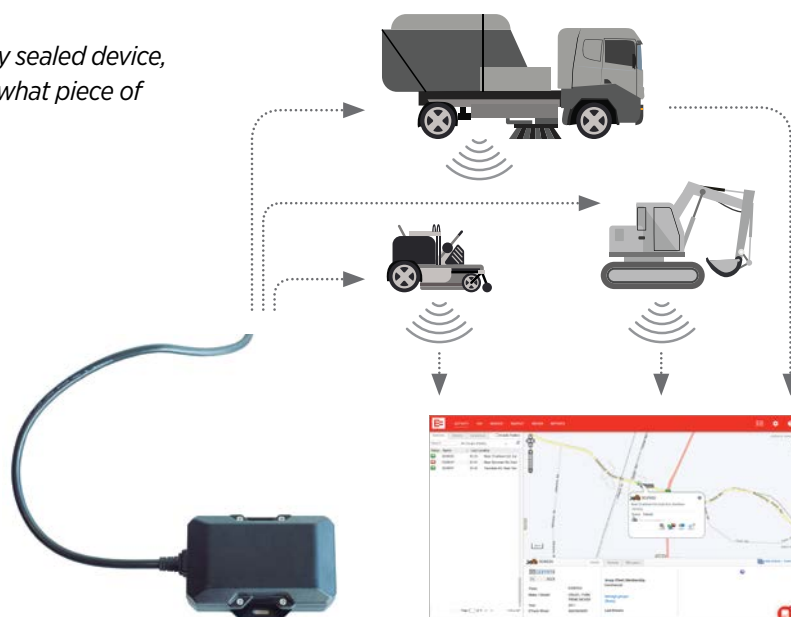

ETrack Wired – Asset Tracker

ETrack Wired is designed to take care of tracking your powered assets and equipment – when you need a full tracking and management solution but don’t require the in-cab experience of the Ehubo2.

The ETrack device is:

- Durable, watertight and IP rated enclosure
- High sensitivity GPS
- Rechargeable backup battery, with up to 6 months life
- 3-axis precision accelerometer
- 2 digital inputs for additional data capture

FEATURES

- › Superior cellular and GPS wireless performance
- › Sealed enclosure to withstand weather (IP66)
- › External surface mountable
- › Internal GPS & GPS antennas
- › Geofence and in-motion alerts
- › 2 digital inputs
- › Detailed historical activity reports

SPECIFICATIONS	
Dimensions	54mm x 110mm x 40mm
Weight	340g with harness
Location Technology	GPS and GLONASS capable
Communication Modes	Cellular (GSM)
Operating Temperature	-20°C to + 70°C
Shock and Vibration	U.S. Military Standard 202G, and 810F, SAEJ1455
Operating Voltage	12 and 24-volt vehicle systems
Battery	Rechargeable lithium ion



One end-to-end solution

EROAD offers a complete suite of user-friendly compliance, regulatory and telematics solutions, including driver safety tools and reports, vehicle maintenance, and fuel and fleet utilisation reporting. Security and accuracy of data is of primary concern in EROAD’s independently tested platform, you can rely on these to provide credible insight and competitive advantage.

See [www.eroad.com.au](http://www.eroad.com.au), or call 1800 437 623 for more information.